



OUTBACK  
MOTORCYCLES

## KTM 390 Adventure R

### ASSEMBLY GUIDE | RECKLESS RACK

#### Tools Required

- ☐ Ratchet + Extension
- ☐ 6mm Allen Socket
- ☐ 8mm Hex Socket
- ☐ Blue Loctite (recommended)

| Number   | QTY | Specifications       | Torque (NM) |
|----------|-----|----------------------|-------------|
| <u>1</u> | 2   | M8 x 40mm Allen Head | *           |
| <u>2</u> | 2   | M8 x 35mm Allen Head | *           |
| <u>3</u> | 8   | M8 Washer            | -           |
| <u>4</u> | 2   | Foot Peg Spacer      | -           |
| <u>5</u> | 2   | 15mm Spacer          | -           |

\* PLEASE REFER TO THE OWNER'S (OR SERVICE) MANUAL FOR **OEM** TORQUE SPECIFICATIONS.\*

STEP 1 (Left Side) :

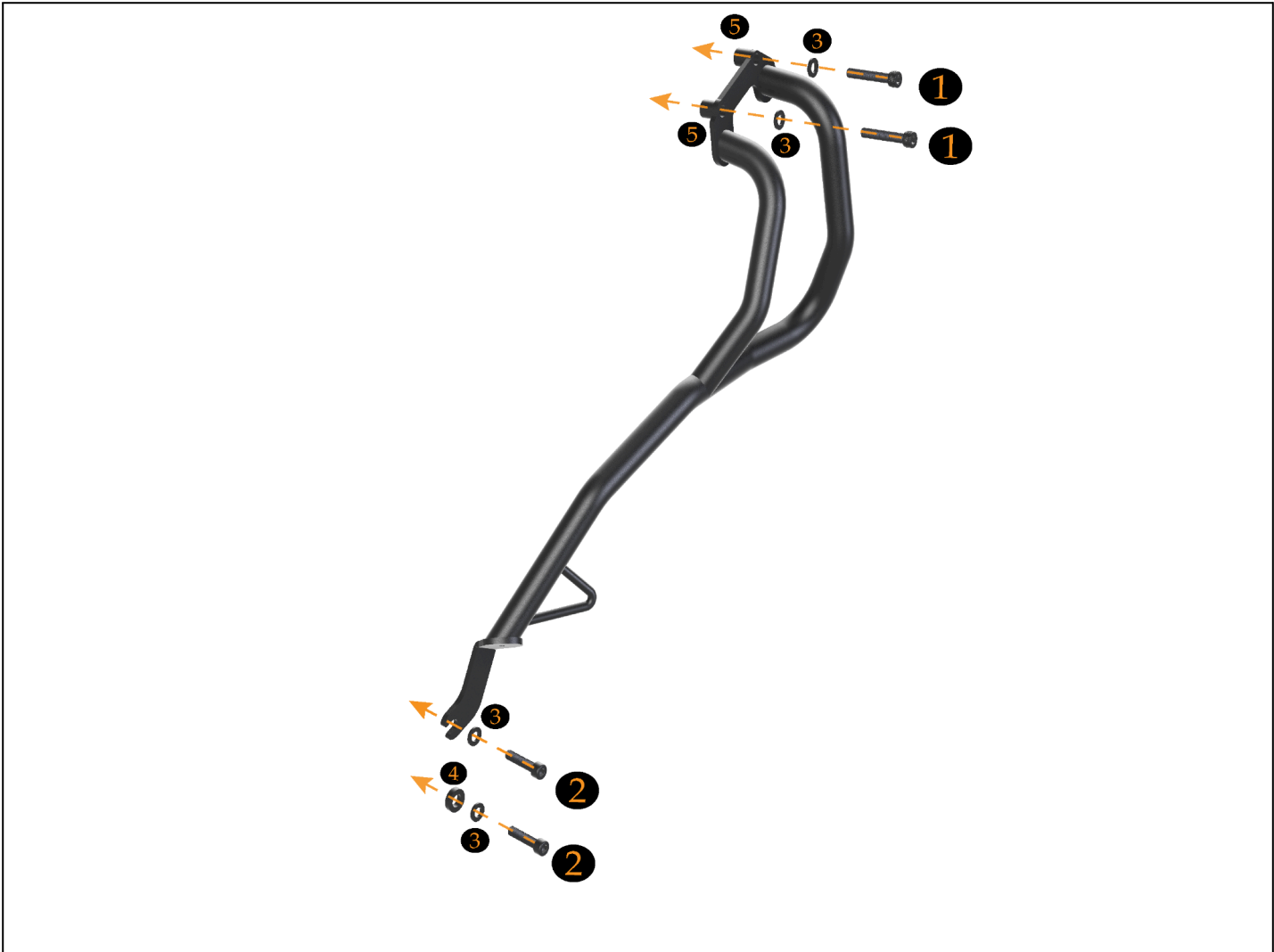

## STEP 2 (Right Side - Identical) :



### \* Torque Disclaimer \*

Torque specs provided by Outback Motortek are for guidance only and may reference OEM data. Incorrect torque application from miscalibrated or improperly stored torque wrenches (which can drift by up to 20% within 12 months) may cause broken studs or mounting failures. Always return torque wrenches to 0 ft-lbs when storing, and use blue Loctite (medium strength) on all fasteners to help prevent loosening. Outback Motortek is not responsible for damage or failures caused by mis-torquing or improper installation.